

By: SANDS SURVEYING, Inc.  
 2 Village Loop  
 Kalispell, MT 59901  
 (406) 755-6481

JOB NO: 277709  
 DATE: October 25, 2021  
 FOR/OWNER: 93 LLC

# EXHIBIT

## LOT 15, 93 LLC



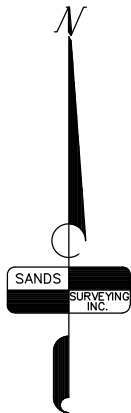
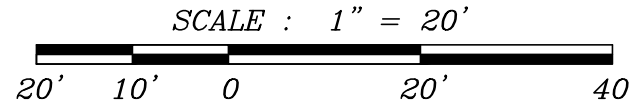

S1/2NW1/4 SEC. 35, T.31N., R.22W., P.M.,M.  
 FLATHEAD COUNTY, MONTANA



### LOT 15

Gross Lot Size: 0.217 Ac. (9439 sq.ft.)  
 Net Lot Size: 0.174 Ac. (7559 sq.ft.)  
 Building Envelope Size: 3342 sq.ft.

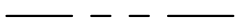
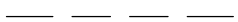
### LEGEND

-  Building Envelope (buildable area)
-  Lot Boundary
-  Road Right-of-Way
-  Utility Easement
-  Major Contour (5' interval)
-  Minor Contour (1' interval)

### Notes:

Contours shown are from 2007 and are pre-construction. Current ground conditions are not shown hereon and are likely different.

This exhibit is for informational purposes only for the lot referenced and does not contain all information pertinent to the lot. Refer to the Final Plat of 93 LLC for all recorded information (conditions, dimensions, total lot boundary, etc).

Building Envelope shown is per 93 LLC PUD zoning setbacks.

The gross lot boundary extends to the centerline of the road easement which is not shown hereon.

If a discrepancy is found between the lot exhibit and the Final Plat, the Final Plat has authority.

